

# MANUAL LUG STYLE PAIL CLOSER

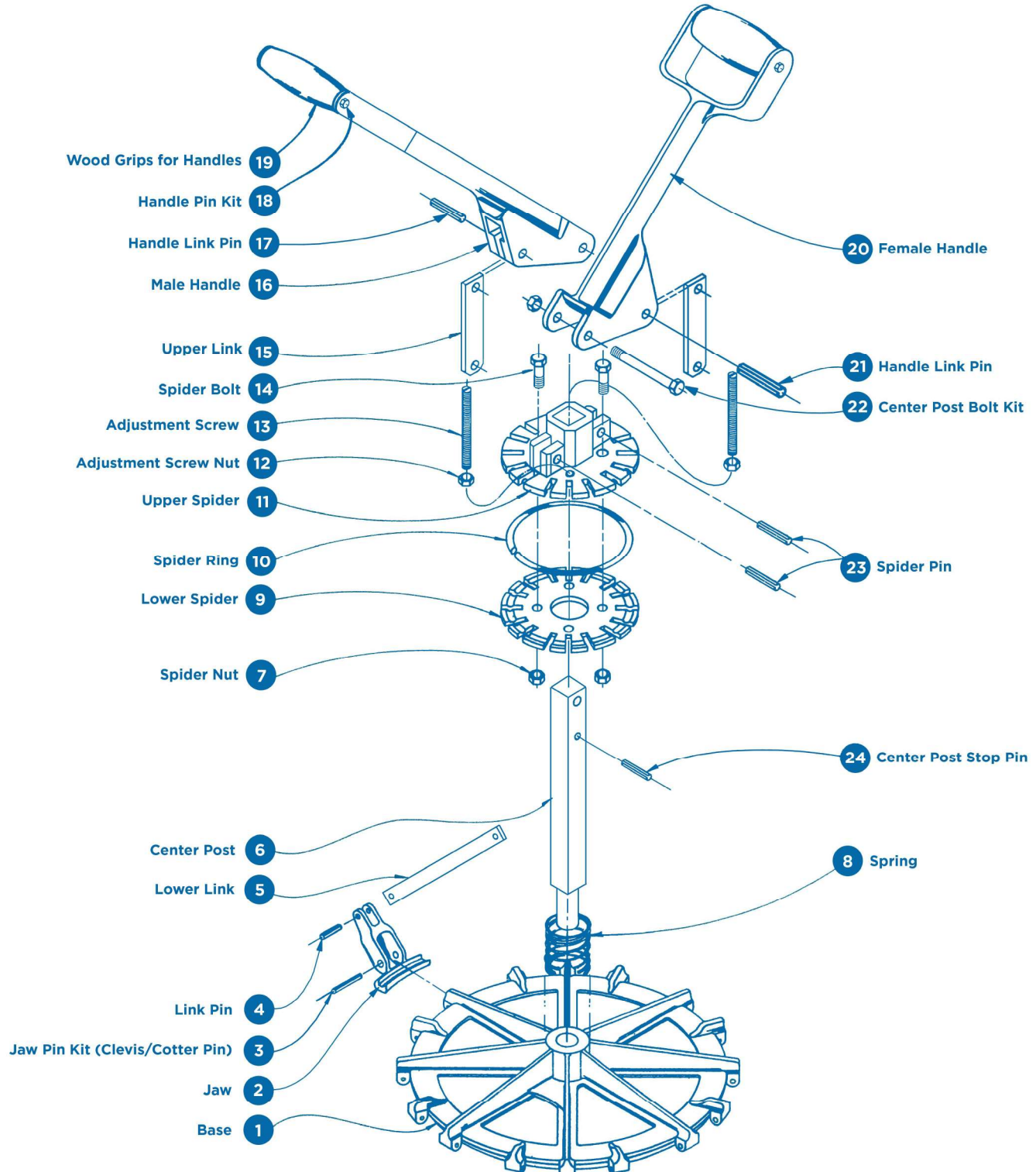



# PARTS LIST - LUG TYPE CLOSERS

CHECK OUT OUR ONLINE SHOP FOR TOOLS & SPARE PARTS: [SHOP.GROTNES.COM](http://SHOP.GROTNES.COM)

DETAIL	DESCRIPTION	GROTNES #	PRICE
1	BASE (SEE NEXT PAGE FOR BASE ORDERING INFO)	**	
2	JAW	CTDM002M9999F	\$ 49.50
3	JAW PIN KIT (CLEVIS & COTTER PIN)	CTK0002	\$ 9.00
4	LINK PIN (STANDARD ISSUE)	SP1_4X7_8	\$ 9.00
4A	LINK PIN KIT (CLEVIS & COTTER PIN)	CTK0003	\$ 9.00
5A	LOWER LINKS (ALUM / BRASS BASE TOOLS)	**	\$ 19.00
5S	LOWER LINKS (STEEL BASE TOOLS)	**	\$ 21.00
6	CENTER POST (SEE NEXT PAGE FOR POST ORDERING INFO)	**	\$ 235.00
7	SPIDER NUT	NUT3_8FZ	\$ 9.00
8	SPRING (SPECIFY IF FOR BRASS OR STEEL BASE TOOL)	**	\$ 30.00
9A	LOWER SPIDER (†ALUM.) FOR 11.25"-16 LUG SIZE TOOLS ONLY	CTDM009A1016F	\$ 310.00
9B	LOWER SPIDER (†BRASS) FOR ALL TOOLS EXCEPT 11.25-16 LUG	**	\$ 375.00
10	SPIDER RING (SPECIFY IF FOR BRASS OR STEEL BASE TOOL)	**	\$ 20.00
11A	UPPER SPIDER (†ALUM.) FOR 11.25"-16 LUG SIZE TOOLS ONLY	CTDM011A1016F	\$ 310.00
11B	UPPER SPIDER (†BRASS) FOR ALL TOOLS EXCEPT 11.25-16 LUG	**	\$ 375.00
12	ADJUSTMENT SCREW NUT	NUT3_8A2Z	\$ 9.00
13	ADJUSTMENT SCREW (SPECIFY TOOL BASE DIAMETER)	**	\$ 9.00
14	SPIDER SCREW	HHB3_8-16X1-1_4_CT	\$ 9.00
15	UPPER LINK	CTDM015S9999F	\$ 23.00
16	MALE HANDLE (*2020 REVISION)	CTDM016AF	\$ 195.00
17	LINK PIN (*FOR TOOLS EQUIPPED W/ 2020 STYLE HANDLES)	SP3_8X1	\$ 9.00
18	GRIP PIN KIT (BOLT & NUT)	CTK0005	\$ 9.00
19	WOOD HANDLE GRIP	CTDM019W9999F	\$ 20.00
20	FEMALE HANDLE (*2020 REVISION)	CTDM020AF	\$ 195.00
21	LINK PIN (*FOR TOOLS EQUIPPED W/ 2020 STYLE HANDLES)	SP3_8X1	\$ 9.00
22	CENTER POST BOLT KIT (BOLT & NUT)	CTK0007	\$ 9.00
23	SPIDER PIN	SP3_8X1-1_2	\$ 9.00
24	CENTER POST STOP PIN	SP1_4X1-1_2	\$ 9.00
HKM	*MALE HANDLE ASSEMBLY KIT (PRE-ASSEMBLED) •CONSISTS OF HANDLE, GRIP/PIN, UPPER LINK/PIN & CENTER POST PIN	CTK0008	\$ 225.00
HKF	*FEMALE HANDLE ASSEMBLY KIT (PRE-ASSEMBLED) •CONSISTS OF HANDLE, GRIP/PIN, UPPER LINK/PIN & CENTER POST PIN	CTK0009	\$ 225.00

## Notes:

- \* PLEASE NOTE THAT A NEW HANDLE DESIGN WAS INTRODUCED IN AUGUST 2020. IF REPLACING HANDLES OUTFITTED ON TOOLS PRIOR TO THIS DATE, IT IS HIGHLY SUGGESTED THAT YOU REPLACE BOTH MALE & FEMALE HANDLES TOGETHER. PLEASE INQUIRE WITHIN FOR ANY QUESTIONS OR CONCERNS YOU MAY HAVE.
- \*\* PLEASE PROVIDE US THE BELOW INFORMATION SO THAT WE CAN DETERMINE THE PROPER ITEM #
  - BASE MAT'L (STEEL OR BRASS)
  - DIAMETER OF TOOL (11.25-16 LUG ETC.)
- † EFFECTIVE AUGUST 2020, ALL 11-1/4" - 16 LUG TOOLS USE ALUMINUM UPPER & LOWER SPIDERS
  - BRASS UPPER & LOWER SPIDERS FOR THE 11-1/4" - 16 LUG TOOL HAVE BEEN DISCONTINUED

Use this page as a reference when needing to order a base or post for your closing tool.

- Posts are permanently fixed into the base at assembly using a process known as "peening".
- We **STRONGLY** urge that when ordering either a post or a base, that you order them together.
- We cannot guarantee proper function of your tool if ordered separately.

## BASES (ALUMINUM, STEEL & BRASS MAT'L)

DETAIL	DESCRIPTION	GROTNES #	PRICE
1.1	6.5" - 8 LUG NON-SPARK BASE (BRASS)	CTDM001B0008F	\$ 550.00
1.2	8.5" - 12 LUG BASE (STEEL)	CTDM001S0512F	\$ 675.00
1.3	8.5" - 12 LUG NON-SPARK BASE (BRASS)	CTDM001B0512F	\$ 650.00
1.4	11.25" - 16LUG BASE (ALUMINUM)	CTDM001S1016F	\$ 550.00
1.5	11.25" - 16 LUG NON-SPARK BASE (BRASS)	CTDM001B1016F	\$ 675.00
1.6	11.25" - 16 LUG BASE (STEEL)	CTDM001A1016F	\$ 700.00
1.7	12.25" - 16 LUG BASE (STEEL)	CTDM001S1516F	\$ 715.00
1.8	13 15/16" - 10 LUG BASE (STEEL)	CTDM001S2010F	\$ 725.00
1.9	13 15/16" - 20 LUG BASE (STEEL)	CTDM001S2020F	\$ 750.00

## SELECT CENTER POST BASED ON TOOL SIZE (DIA) & STYLE (MANUAL TOOL OR HEAD ONLY TOOL)

DETAIL	DESCRIPTION	GROTNES #	PRICE
6.1	MANUAL TOOL (BRASS OR ALUMINUM BASE)	CTDM006Z9999F	\$ 235.00
6.2	MANUAL TOOL (STEEL BASE)	CTDM006S9999F	\$ 235.00
6.3	10 OR 20 LUG TOOL (STEEL BASE - MANUAL OR HEAD ONLY)	CTDM006S9920F	\$ 235.00
6.4	HEAD ONLY TOOL (BRASS OR ALUMINUM BASE)	CTDH006Z9999F	\$ 235.00
6.5	HEAD ONLY TOOL (STEEL BASE)	CTDH006S9999F	\$ 235.00

EXAMPLE OF THE POST "PEENED"  
INTO THE BASE AT ASSEMBLY

