



GROTNES

MANUAL LUG TYPE PAIL CLOSER

FOR MANUALLY CLOSING LIDS ONTO STEEL PAILS

CHECK OUR ONLINE STORE FOR PRODUCTS & SPARE PARTS: [HTTPS://SHOP.GROTNES.COM](https://shop.grotnes.com)

Tool Maintenance / Warranty

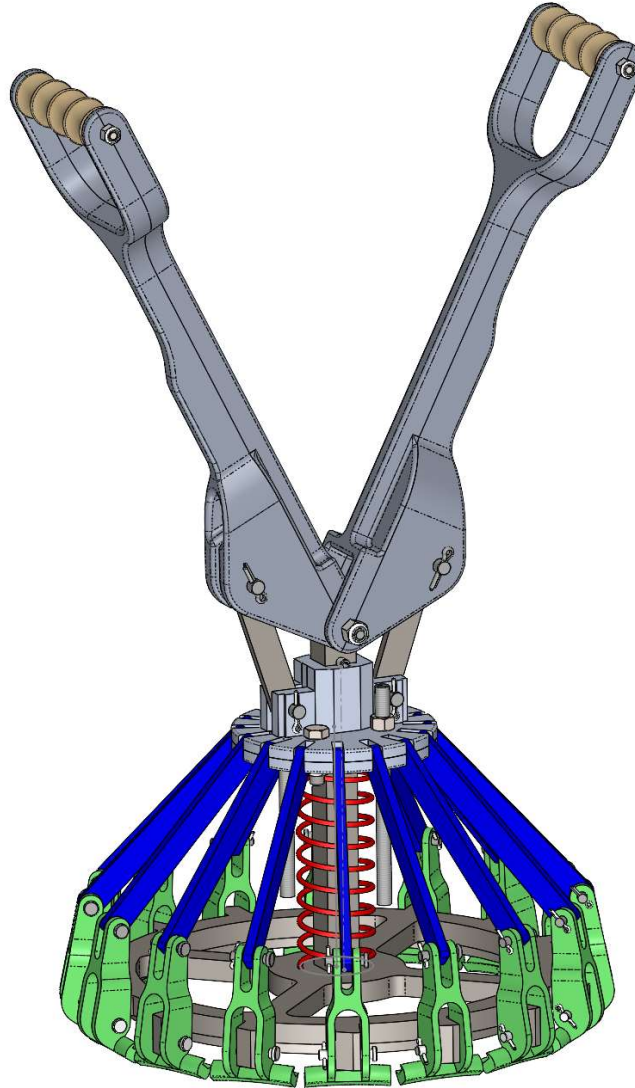

CTM16A – 16 LUG ALUMINUM BASE MANUAL TOOL

CTM16B – 16 LUG BRASS BASE MANUAL TOOL

CTM16S – 16 LUG STEEL BASE MANUAL TOOL



GROTNES

MANUAL LUG TYPE PAIL CLOSER

FOR MANUALLY CLOSING LIDS ONTO STEEL PAILS

CHECK OUR ONLINE STORE FOR PRODUCTS & SPARE PARTS: [HTTPS://SHOP.GROTNES.COM](https://shop.grotnes.com)

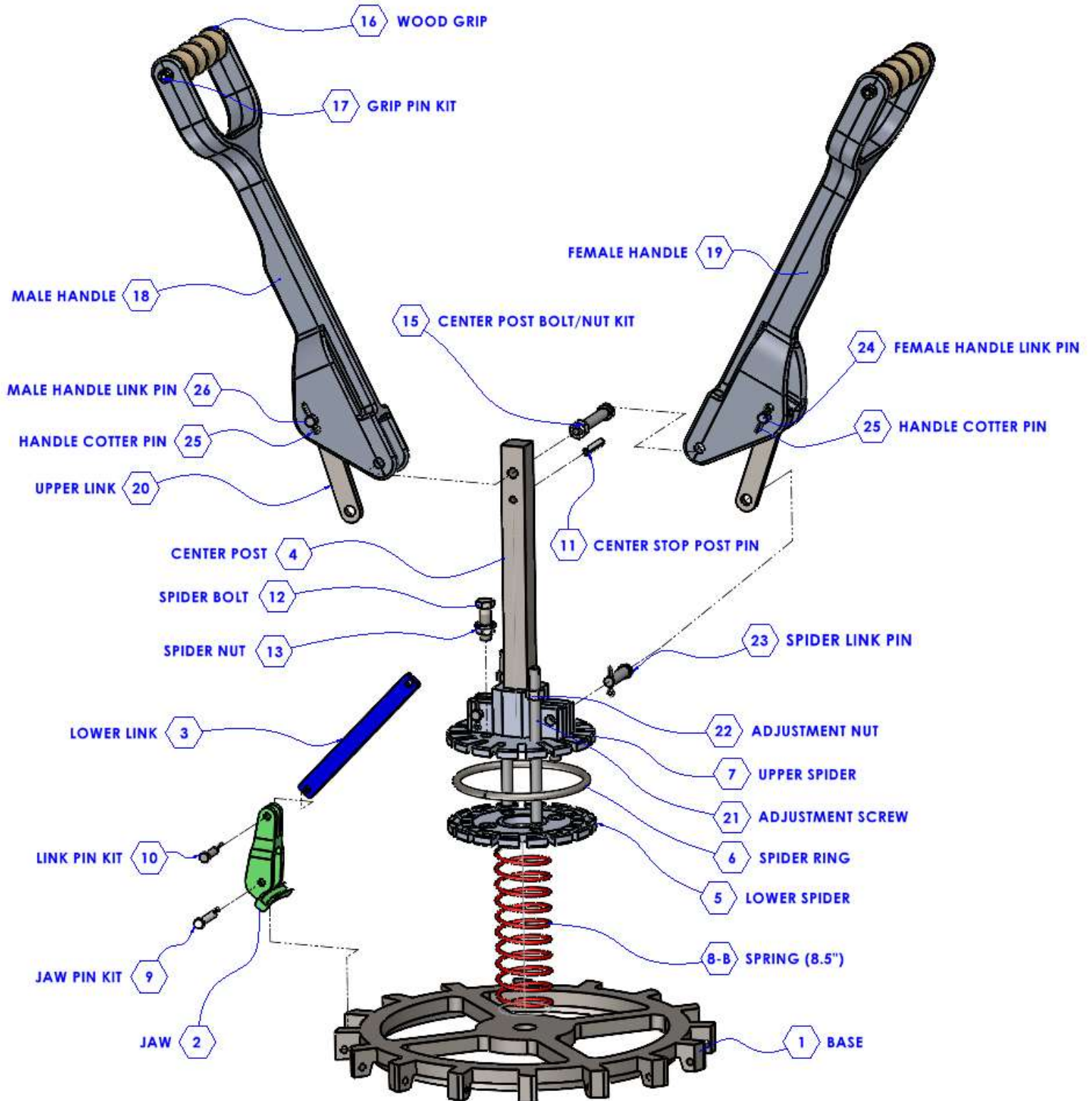



Setting the Unit onto a Lid.

- Lift the tool onto a pail & lid
 - Make sure the lid is seated onto the curl of the pail
- Align the jaws of the tool to the tabs of the lid



Closing the Pail

- Push the handles manually outward to actuate the links
 - Apply continued pressure until the tabs of the pail are crimped onto the lid
- It may be necessary to turn the head and close the tabs again depending on the gauge combination of the pails and lids
- Please do not push the handles too far apart
 - This will cause undue stress on the handle
- Actuating just past the shoulder width is a good guide to follow
 - This is just a guide and not the rule.



Removing the Tool

- Make sure that the handles are in the upright position and the jaws and all the pail tabs are clear.
- Lift the tool and set it to the side
 - Place on a soft surface, such as cardboard, so that the jaws are not damaged or chipped on the floor, or by any other accident.



Keep Tool Clean

- Remove any paint or debris from Jaws or Base to assure proper closer
 - Failure will result in uneven closer or poor crimps
 - This should be performed weekly



Lubrication

- Lubricate all moving parts
 - This would include link pins, jaw pins, center post, jaws, links, center post bolt, and upper link
 - This should be performed weekly





Tighten Bolts

- Make sure that spider bolts are tightened and no gap is forming between Upper Spider and Lower Spider plate
 - Failure will result in premature wearing of spider ring and lower link
 - This should be performed monthly



Wear Items

- As the tool is used over time normal wear and tear will develop
 - The areas that wear fastest are the lower links, link pins, jaw pins, spider ring, and the spring
 - These should be inspected monthly
 - Items that show wear wearing should be replaced.





Proper Crimp Images

CORRECT



Correct Close

INCORRECT



Too Open

INCORRECT



Too Tight



Crimp Adjustments

- To increase closing action, turn 3/8" adjusting bolt upward (Detail #21)
- To decrease closing action, turn 3/8" adjusting bolt downward (Detail #21)
- Tighten 3/8" nut with wrench to set the new position (Detail #22)

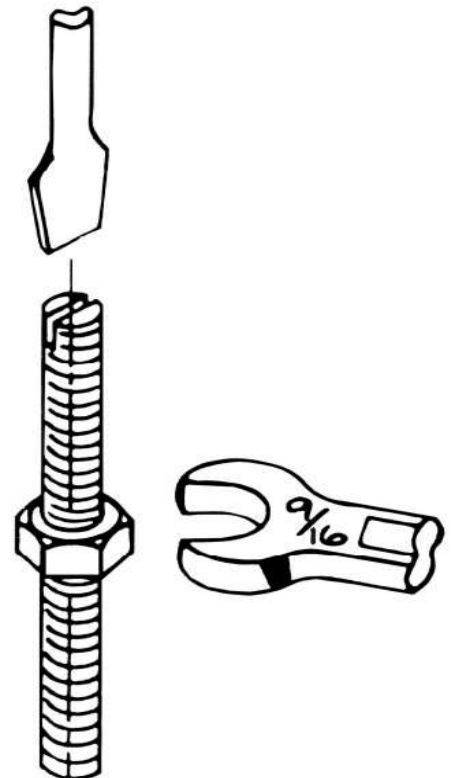



LUG TYPE CLOSER WARRANTY

FOR MANUALLY CLOSING LIDS ONTO STEEL PAILS

CHECK OUR ONLINE STORE FOR PRODUCTS & SPARE PARTS: [HTTPS://SHOP.GROTNES.COM](https://shop.grotnes.com)

Grotnes warrants each unit of machinery manufactured by it to be free from all latent defects in material and workmanship disclosed under normal use and service for a period of one year from date equipment is received at the purchaser's facility. The purchaser shall notify Grotnes immediately of any defective parts and Grotnes shall at its sole option repair or replace parts or return the pro-rata portion of the purchase price. Grotnes shall not be held liable for damage or delay caused by defective parts and will not accept any charges for work performed by purchaser in making adjustment or repairs without written authorization in advance.

In the case of standard apparatus furnished but not manufactured by Grotnes such as motors, controls, pneumatic and hydraulic equipment etc., Grotnes extends to you the same guarantee as is given us by the respective manufacturers.